

- THE -
**SHELL
GROTTO**
MARGATE

Sensory Map

This Sensory Map shows you all the sights, sounds and smells you might experience at the Shell Grotto.

For full access, travel and visitor information, see our Access Statement. We also have a Visual Story available.

shellgrotto.co.uk/visit

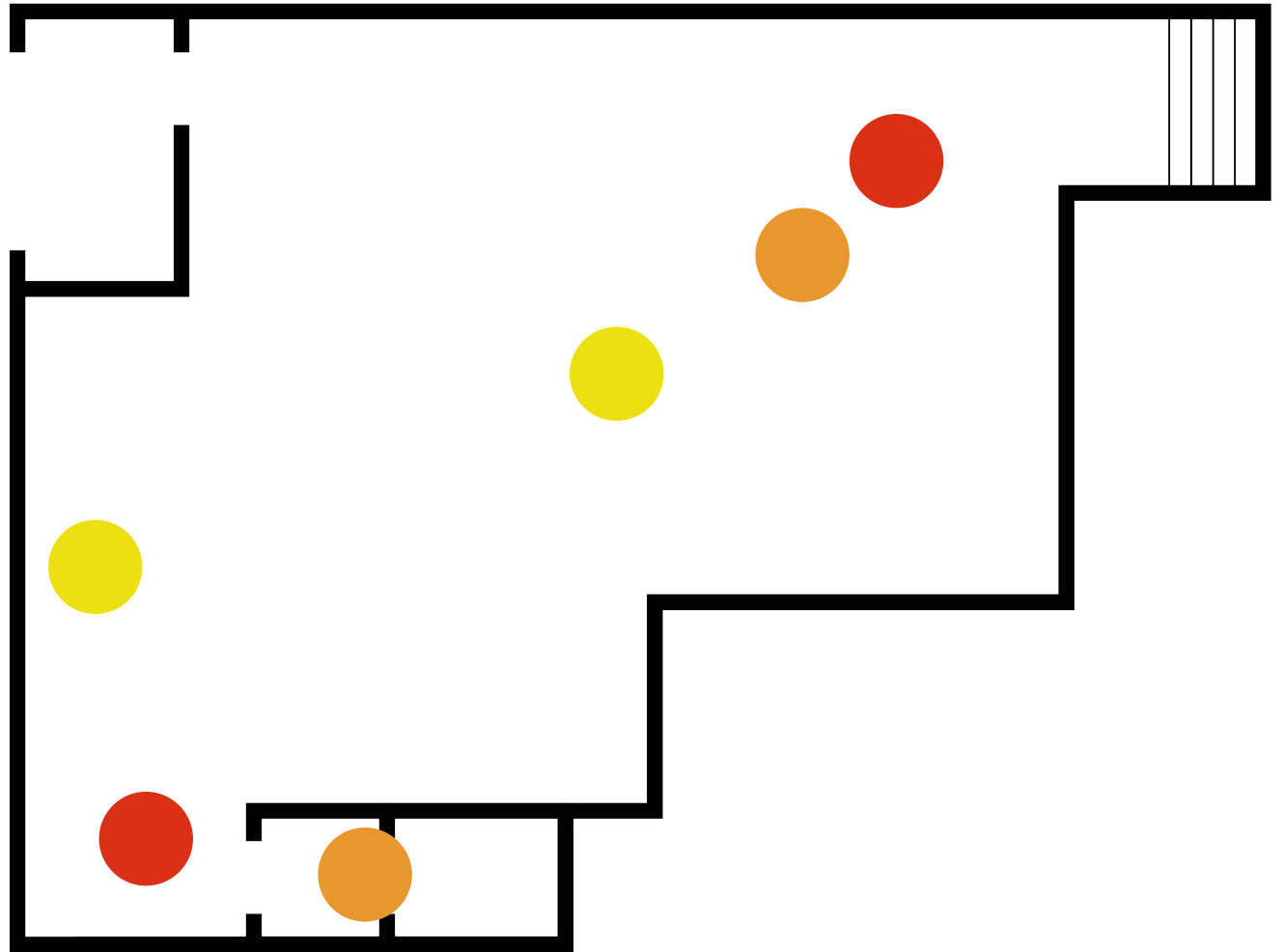

Updated: Feb 2024



Reception/Shop

The Reception and Shop are brightly lit. When it is busy, it can feel cramped and noisy and you may need to queue to get into the Grotto.

There is one public toilet available. The hand dryer is noisy and there might be a queue to use the toilet when it is busy.

-  **Noisy Space** - The reception and hand dryer in toilet can be noisy
-  **Bright Space** - There are large front windows and a skylight above
-  **Busy Space** - Queues can form for reception and the toilet

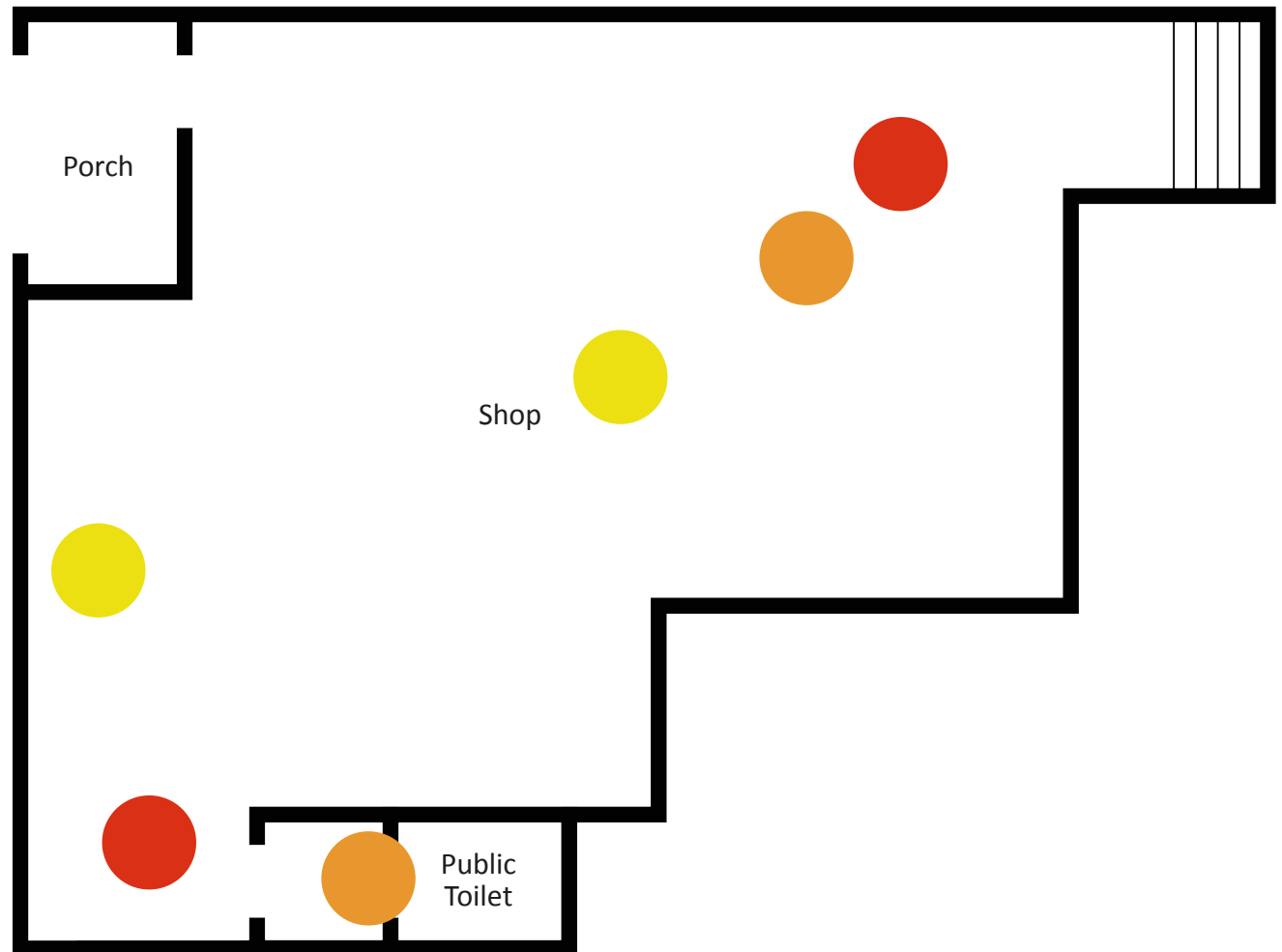

The Museum

The museum is dimly lit and can feel cramped and noisy when it is busy.

There are lots of interactive activities in the museum which you can touch and play with.

 **Busy Space** - The museum is small with a table in the middle

 **Dark Space** - The museum is very dimly lit

 **Interactive Space** - There are some activities to touch and play with

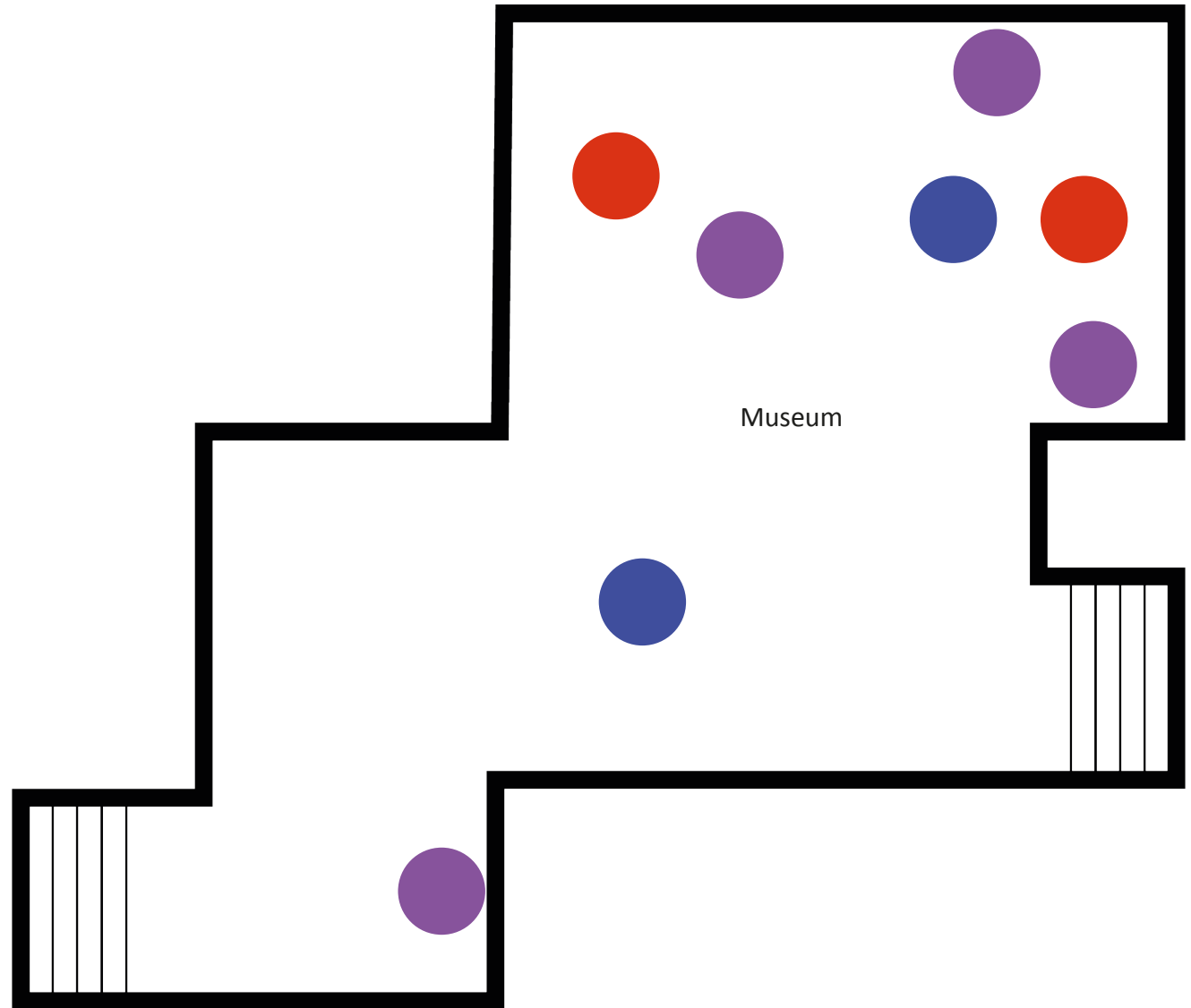

The Grotto

The Grotto might smell damp and is dimly lit. There is some natural light in the Dome which can appear bright.

The Grotto is small and can feel cramped when it is busy. The floor is steep and uneven and voices echo through the tunnels.

-  **Busy Space** - The Grotto is narrow and queuse can form
-  **Dark Space** - The Grotto is dimly lit
-  **Smelly Space** - The Grotto can smell like damp earth
-  **Bright Space** - Light from the roof of the Dome can appear bright

